

# DUPLEX SKY HIGH RESIDENCE WITH UNINTERRUPTED SEA VIEWS

6 900 000 €

<b>Property Code:</b>	249	<b>Type:</b>	Sale - Apartment
<b>Location:</b>	Limassol - NEAPOLIS	<b>Internal Area:</b>	222.5 m <sup>2</sup>
<b>Bedrooms:</b>	3	<b>Bathrooms:</b>	3
<b>Distance to the sea:</b>	20 m	<b>Distance to airport:</b>	65 km
<b>Status:</b>	Off Plan	<b>VAT:</b>	Plus
<b>Covered verandas, m<sup>2</sup>:</b>	48.6		

## Property features:

Common Pool	Unfurnished	Parking - Covered	Telephone Line
Store Room	Solar panels for hot water	Double Glazing	Parking
Balcony			

## Description:

The tallest residential seafront tower in Europe and the most groundbreaking development in the history of Cyprus. At 37 storeys' it will redefine the ultimate Limassol view. For exceptional seafront living, for exclusivity, for security of investment, this project will be the most iconic address not only in Cyprus but the region as whole. The project offers unparalleled living facilities with the visionary development creating a new category of luxury living in Cyprus. Offering the sanctuary of home and the service of a hotel, residents will have unlimited access to an exclusive spa, fully-equipped fitness centre and swimming pool with extended sun decks and outdoor terrace. And, in order to ensure residents enjoy the very best project has to offer, owners of the impeccable apartments will also have a comprehensive, 24 hour concierge service at their full disposal. These all-encompassing facilities will be further complimented by an area dedicated to premium dining and shopping, stretching across two floors of the coveted tower. With a maximum of just three apartments per floor, every residence will enjoy unrivalled, unobstructed sea views, also capturing views over the city and to the Troodos Mountains beyond. The Residences are ingeniously designed with uninterrupted flow of space running from one side of the tower to the other - capturing high levels of natural light. As you would expect from a development of this calibre and standard, the interior finishes and fittings have been designed by highly awarded London based interior designers, ensuring that living areas are as practical as they are beautiful, emphasizing their natural surroundings. The concierge services, temperature-controlled wine storage facility, business centre and secure underground parking combine to offer a new benchmark for luxury living. Double-height atriums, open-plan grace and radiant finishes define the residences' superior quality. The 270° views through magnificent full-height windows or from the outdoor balconies are awe-inspiring. The city, the mountains, the vast Mediterranean Sea and the curve of the horizon form a living landscape that juxtaposes nature with urbanity. Imaginative, spatial design - playful on one hand and instinctive on the other - creates effortless flow throughout the expansive residences. Décor is bold, contemporary and pure.

### Facilities

- 24-hour reception
- Concierge service
- Secure car park
- Bicycle parking
- Outdoor swimming pool with deck area

## DUPLEX SKY HIGH RESIDENCE WITH UNINTERRUPTED SEA VIEWS

---

6 900 000 €

- Spa with treatment room, sauna, steam bath
  - Gym
  - Meeting room
  - Business centre
  - Wine cellar
  - Outdoor children's playground
  - Children's pool area
  - Outdoor sitting area/terrace
  - Wi-Fi coverage of communal areas
- Extra benefits
- Three years' free golf membership

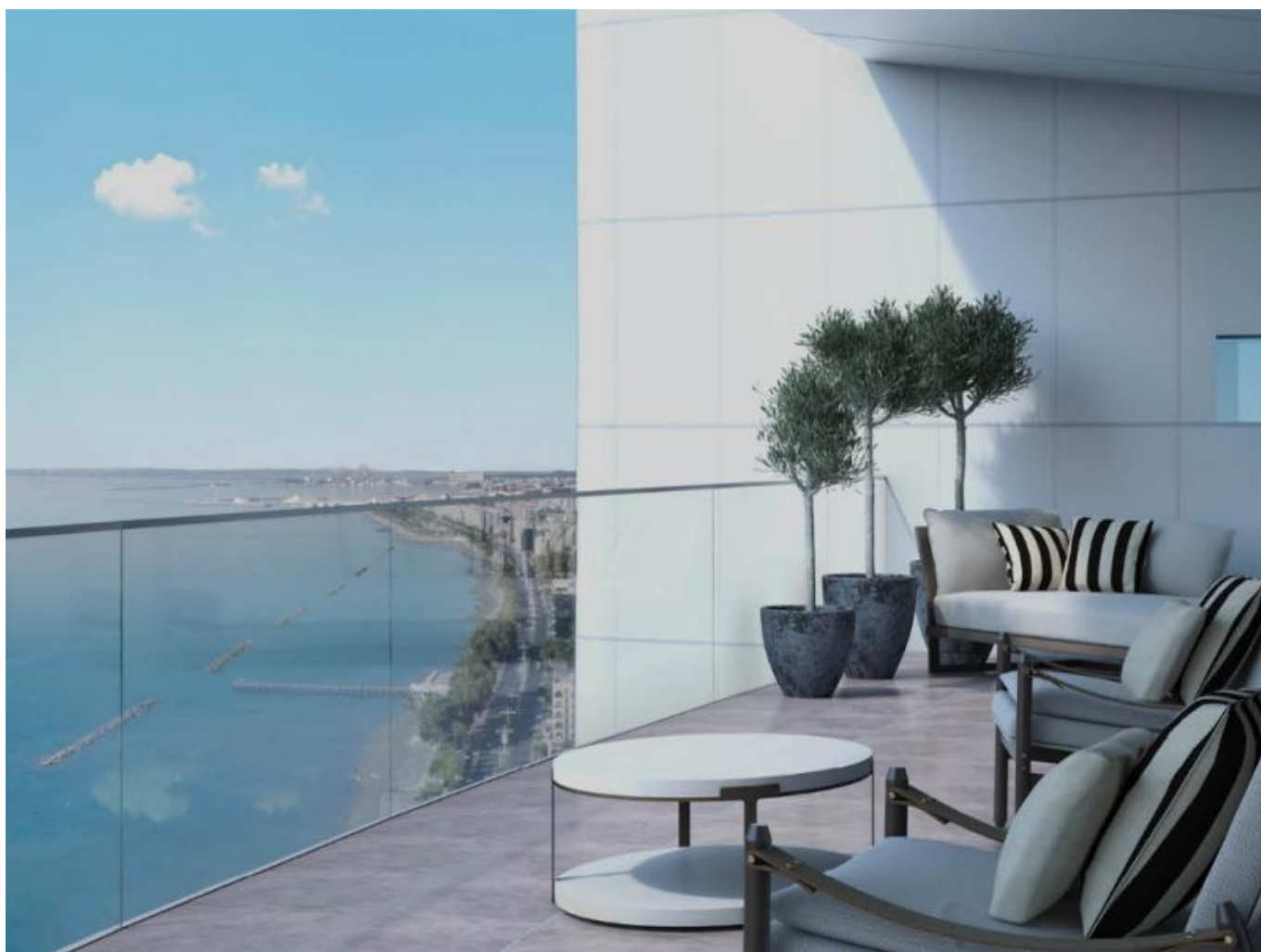

**DUPLEX SKY HIGH RESIDENCE WITH  
UNINTERRUPTED SEA VIEWS**

6 900 000 €

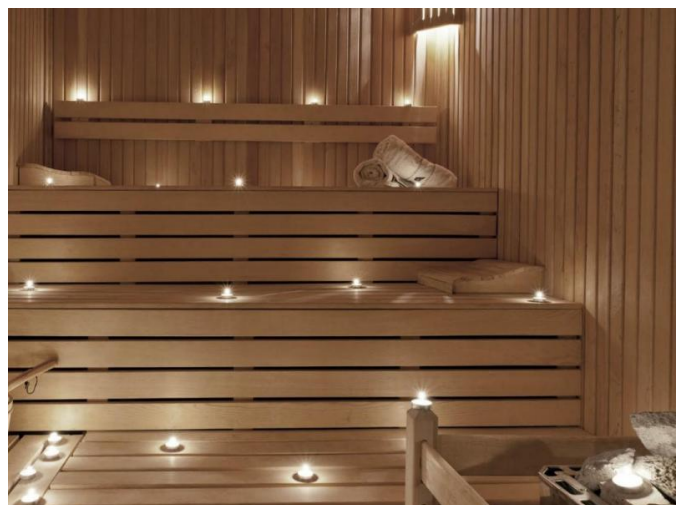
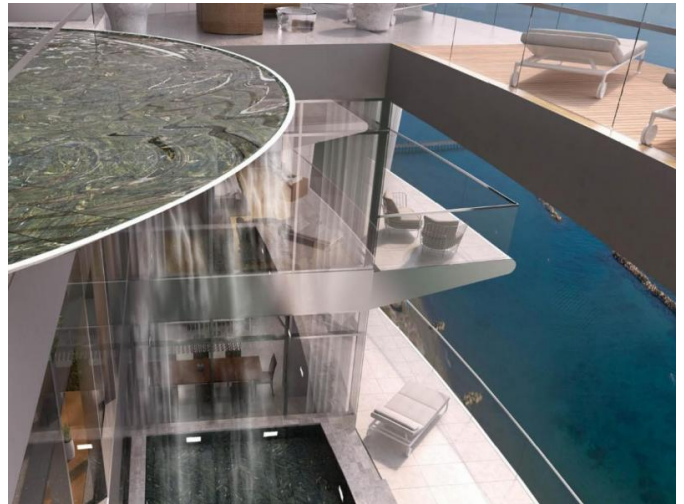

**DUPLEX SKY HIGH RESIDENCE WITH  
UNINTERRUPTED SEA VIEWS**

---

6 900 000 €

